

Travelling to Rye St Antony

By Rail: Oxford is the nearest mainline station, with regular connections to London Paddington and Birmingham, and the School is 15 minutes away by taxi or by bus (to the Gypsy Lane Brookes University stop).

By Road: Approaching Oxford from either the northern or the eastern bypass, at the Headington Roundabout, take the exit onto the A420 London Road. Continue for 1 mile and turn north at the White Horse public house onto the B4495 Headley Way. Take the second turning left onto Franklin Road. Continue straight ahead, and the main entrance to Rye St Antony is on the right after 50 metres. Please note that the postcode for the Pullen's Lane entrance is OX3 0BY and the postcode for the Franklin Road entrance is OX3 7SA

On Arrival: Visitors are requested to report to Reception in the Rendall Building.

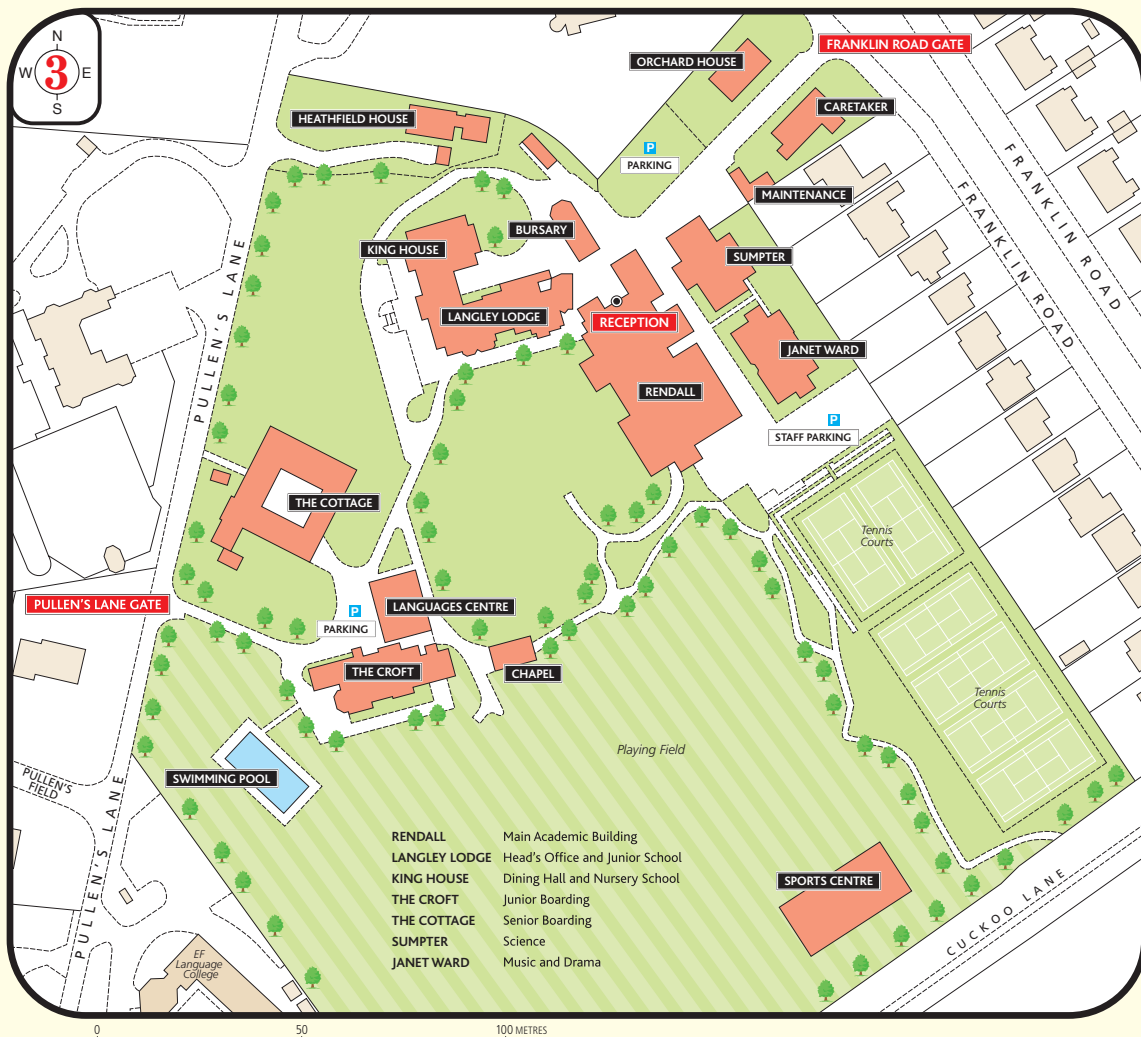

Published by Location Maps Ltd. Tel: 01276 475879. www.locationmaps.com
 © U.K. Design Copyright Location Maps Ltd. All rights reserved. No part of this publication may be produced, stored in a retrieval system, or transmitted, in any form, or any means, electronic, mechanical photocopying, recording or otherwise, without the permission of the publishers and copyright holders. The contents of this Location Map are believed to be correct at the time of printing. Nevertheless Location Maps Ltd., can accept no responsibility for errors or omissions or changes in the detail given.